

ASSEMBLY

Tia Conference

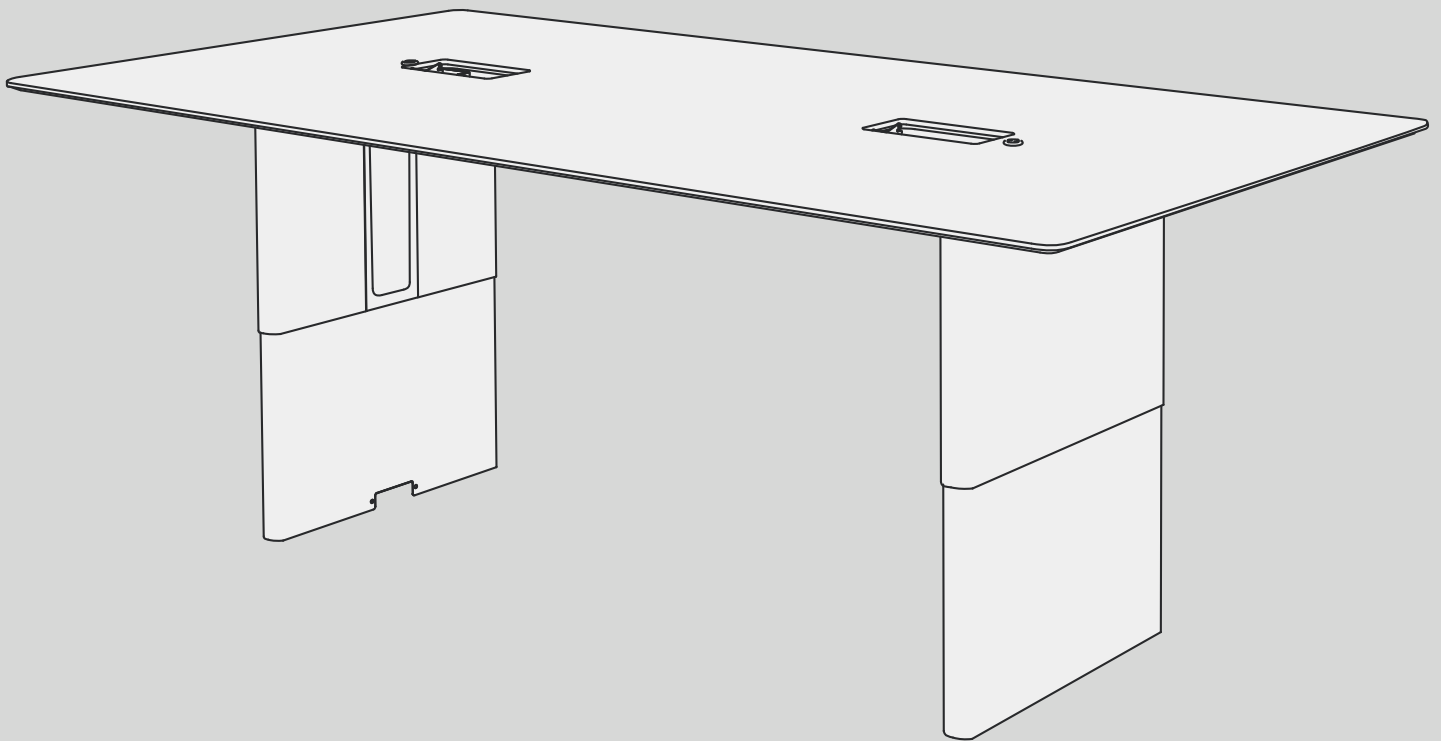

Tia Conference Table Typical

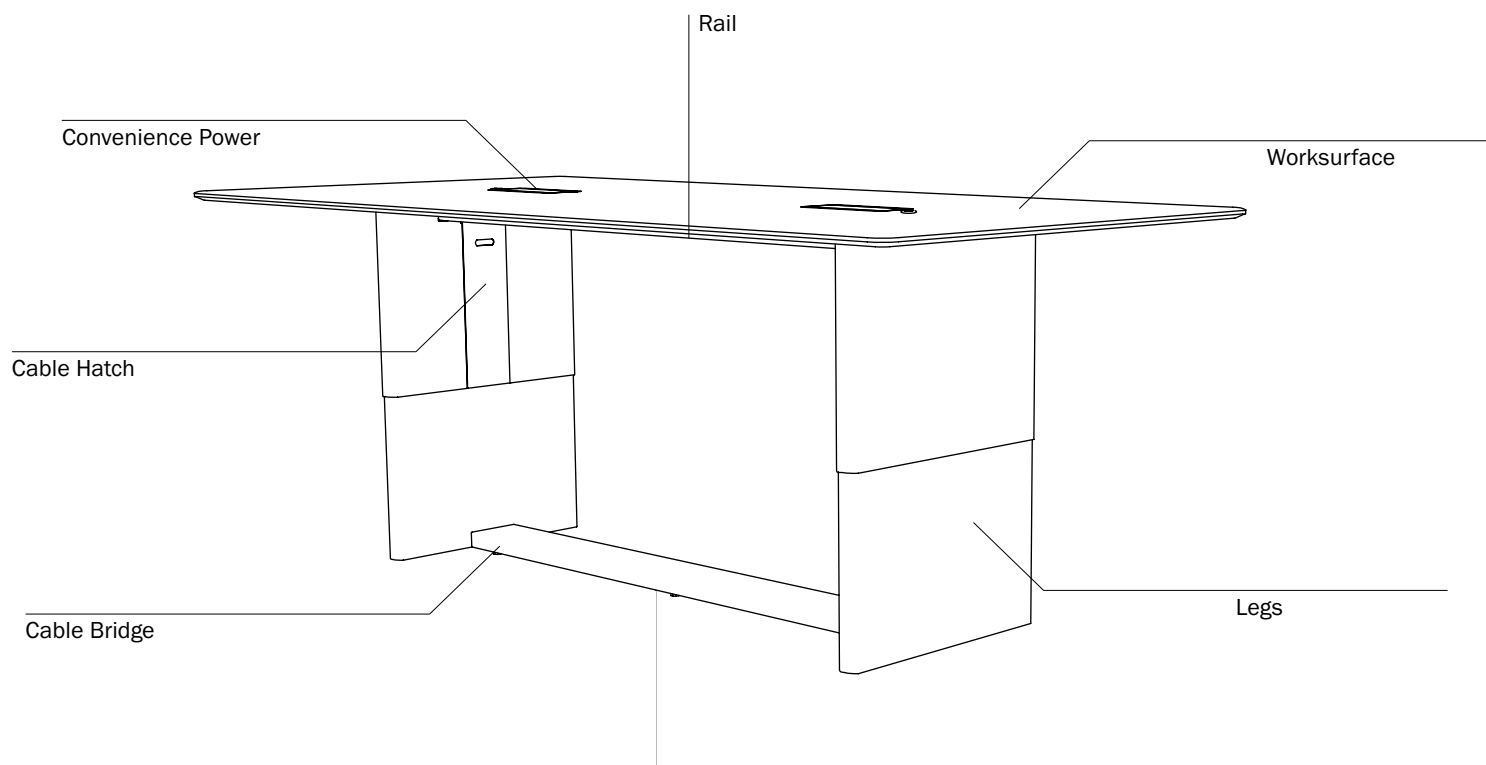

WARNING — Risk of Fire or Electric Shock. It is possible for this office furnishing system to be connected to more than one source of supply. Disconnect all sources prior to any servicing. A single circuit shall not be powered by more than one source.

WARNING - For commercial use only.

Fasteners



#10x1"
Pan Head Wood
Screw (122850)



#10x5/8"
Pan Head Wood
Screw (122800)

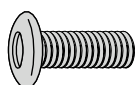

M6-1x12mm
Button Head Socket
Cap Screw (125290)



10-32 x 3/8"
Phillips Machine
Screw (121376)



Black
Push Rivet
(0000822)

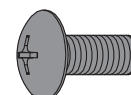

1/4-20x5/8"
Pan Head **Phillips**
(117051)

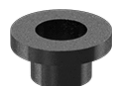

1/4"
Bushing
(0000826)



Alligator Clip
(117051)

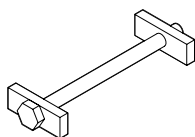

Tite Joint Connector
Bolt 1/4-20 x 3.5"
(490006)

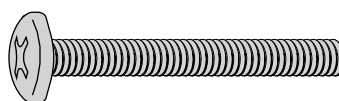

M6-1x40mm Phillips Pan
Head Machine Screw
(125293)



M6-1x12mm
Nylock Nut
(888152)

Tia Conference Table Basic Components

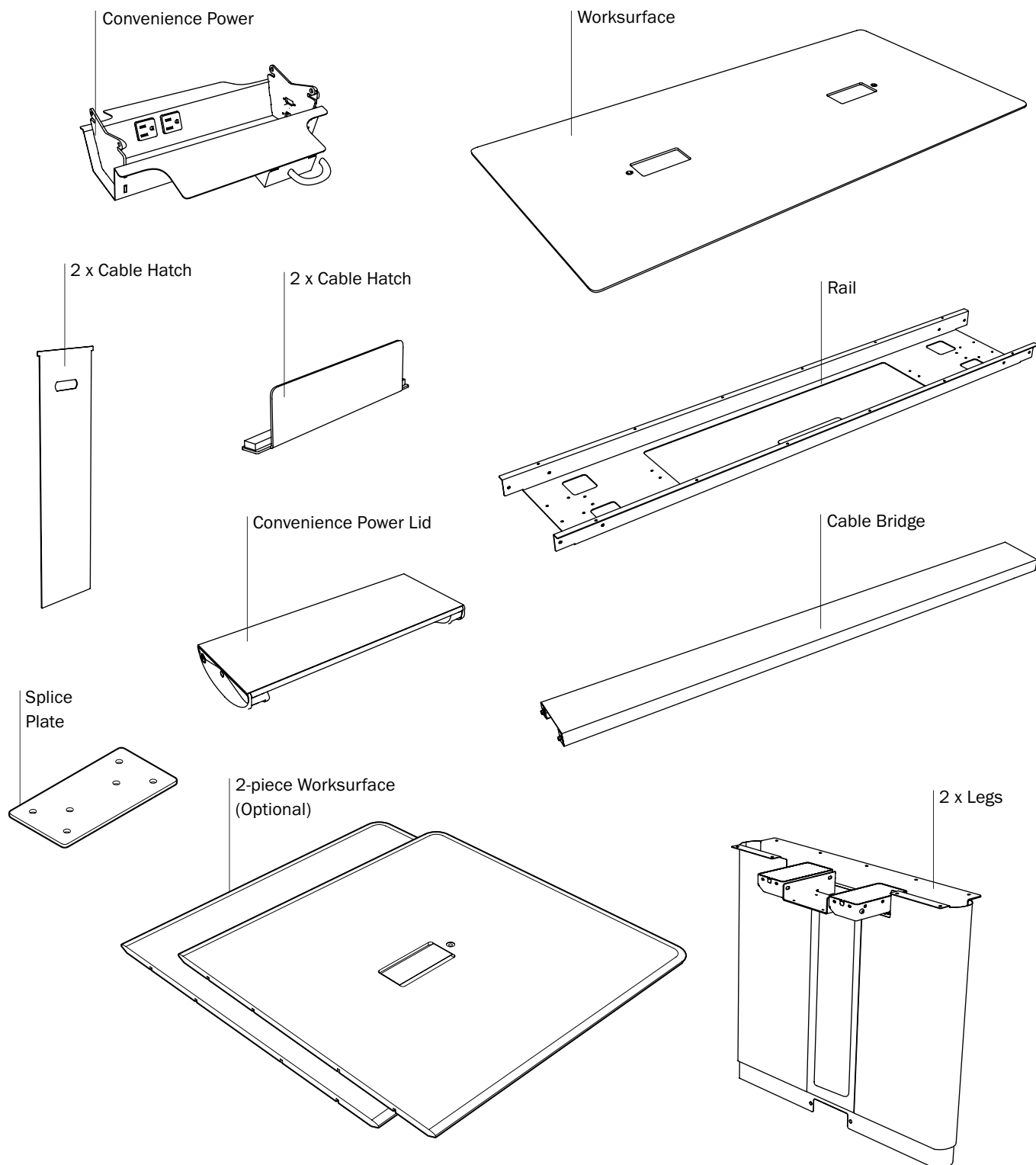

1.

Secure Legs to Rail

Secure the Legs to the Rail with 16 M6 screws. 8 screws are driven from the underside of the rail while the other 8 are driven from the sides of the rails in the holes shown below.



M6-1x12mm
Button Head Socket
Cap Screw (125290)

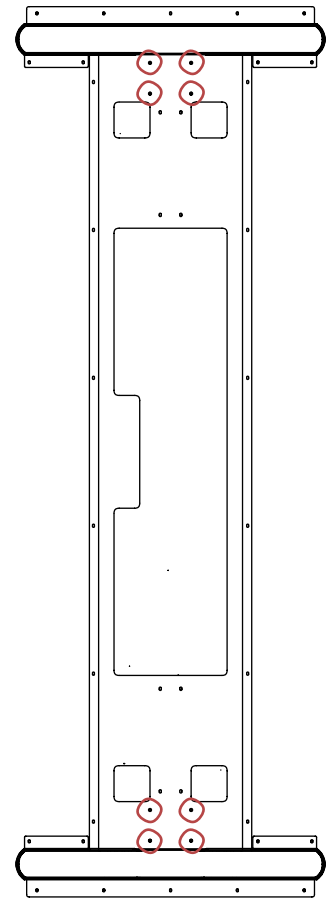
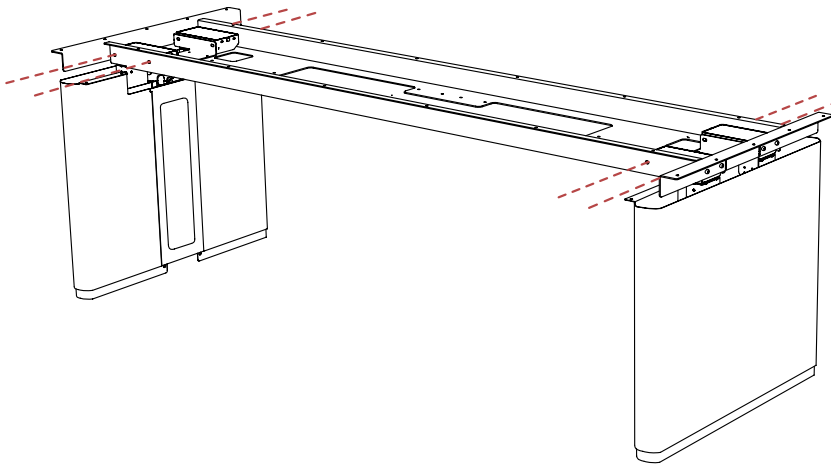

2.

Raise Legs

Connect the 4 legs to the control box. Plug the control box into a power source and temporarily attach a control switch. Raise legs to max stroke.

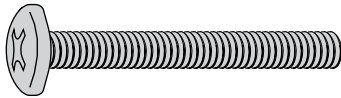

M6-1x40mm Phillips Pan
Head Machine Screw
(125293)



M6-1x12mm
Nylock Nut
(888152)

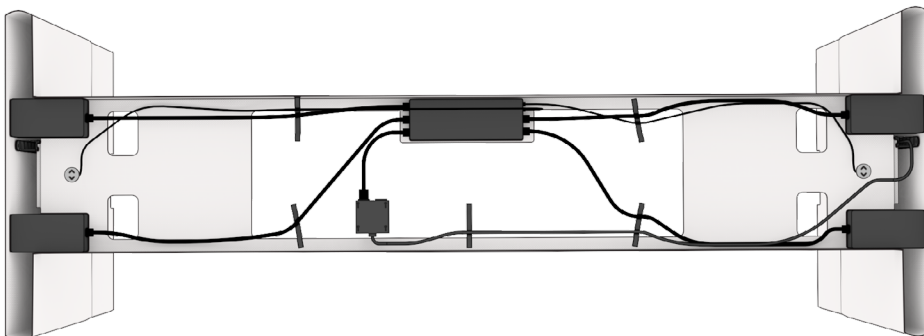
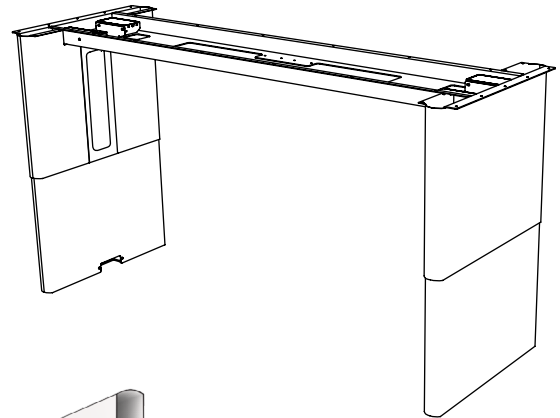

3.

Optional: Convenience Power

Secure the convenience powers unit to the rail with 4 screws per unit in the holes shown below.



x 8

10-32 x 3/8"
Phillips Machine
Screw (121376)

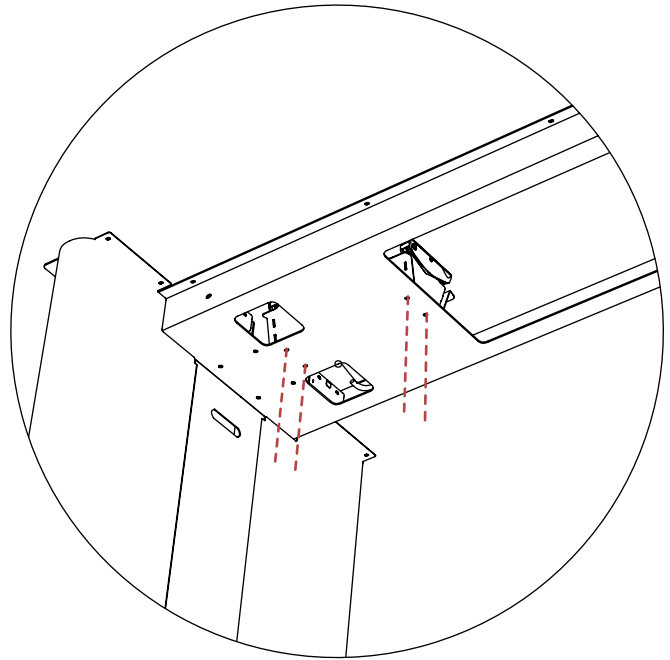
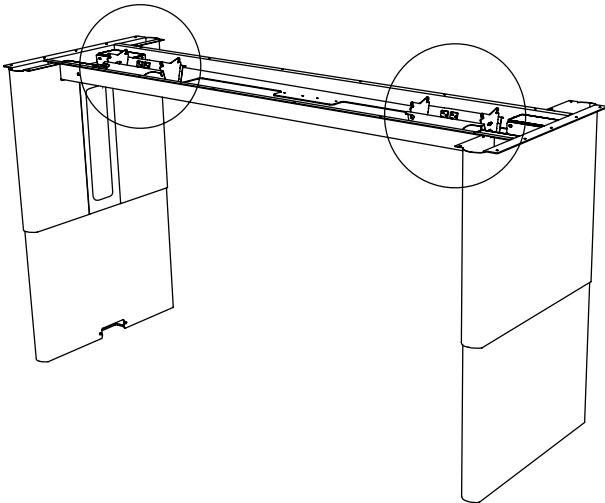

4.

Cable Routing

Route cables into either leg. Snap the cables into the energy chain, and then route them through the opening at the bottom of the leg.

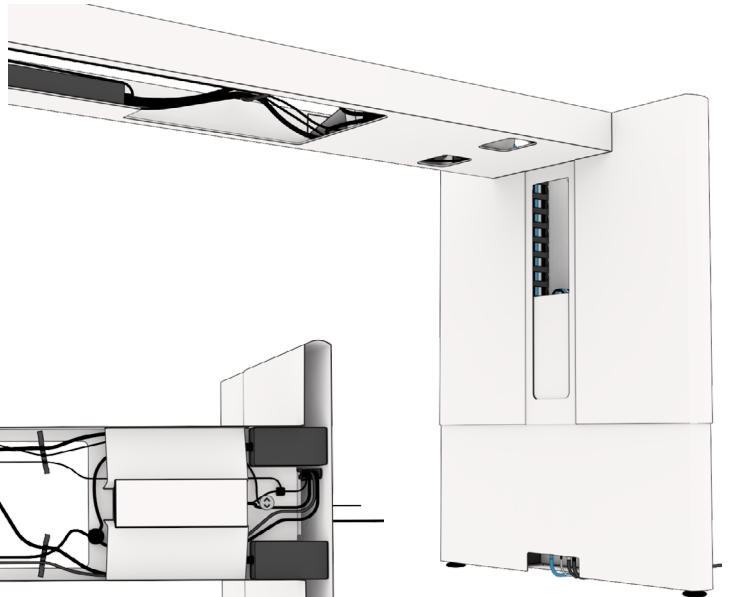
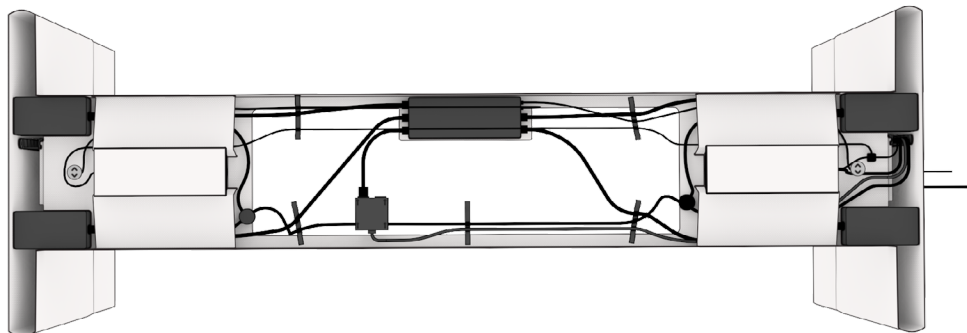

5.

Worksurface

Place the worksurface on the leg/rail assembly. Place the control switches in the worksurface dados and route the cables to the control box. Then secure the surface to the rail with 22 wood screws in the holes shown below.

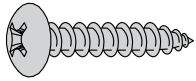

x 22

#10x1" Pan Head Wood
Screw (122850)

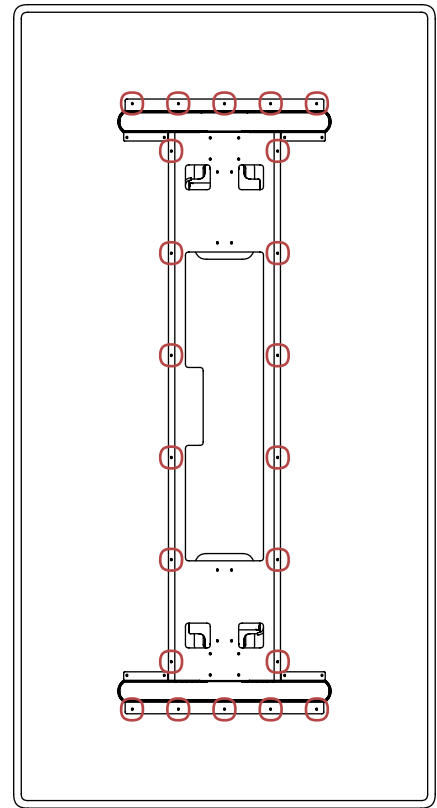
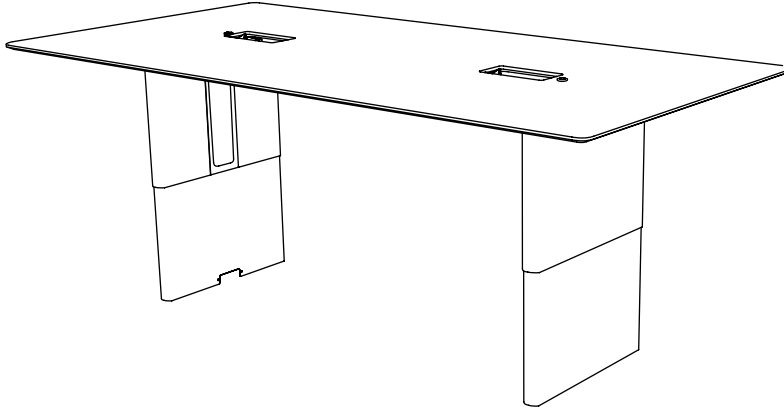

2-Piece Worksurface (Optional)

Place the worksurfaces on the rail spaced apart. Slide the the two halves of the two-piece worksurface together, inserting the plastic bar into the dado of the opposing surface. Clamp the surfaces together using 4 hex-head joint clamps (490006). Screw the splice plates to keep the tops aligned.

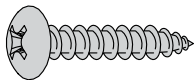

#10 x 1" Pan Head Wood
Screw (122850)

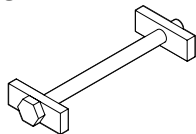

Tite Joint Connector Bolt
1/4-20 x 3.5" (490006)

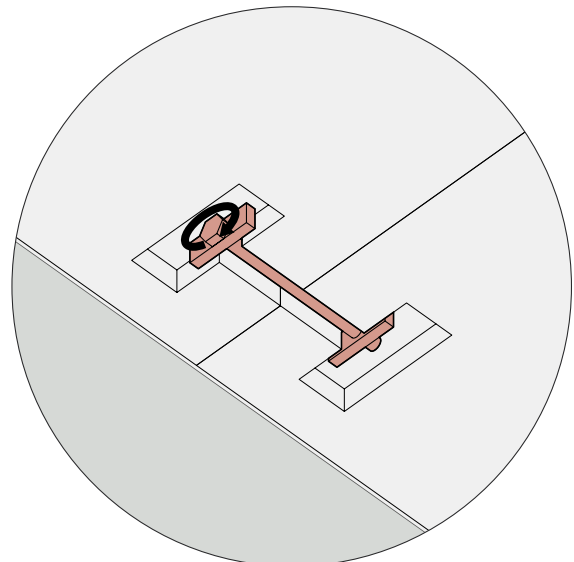
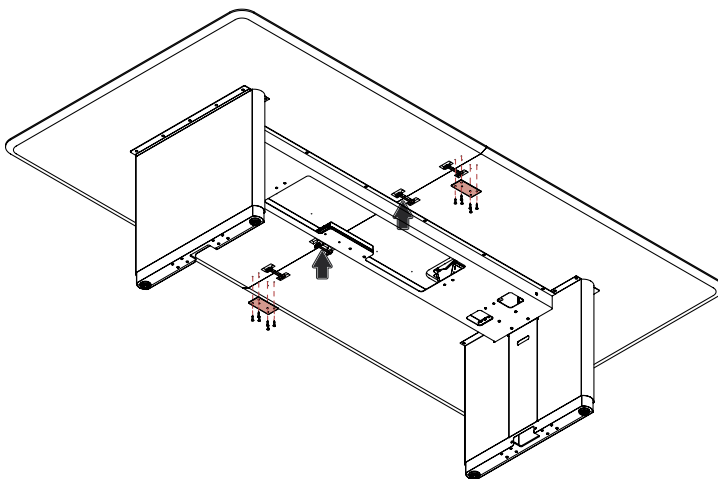
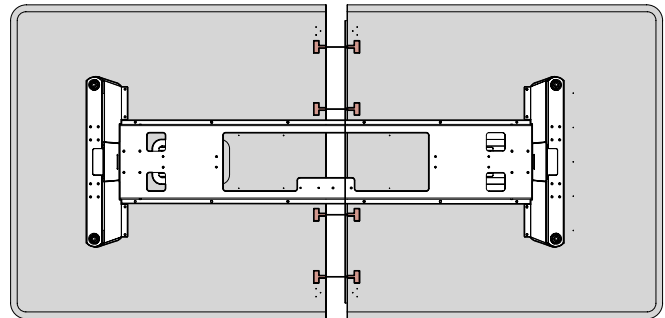

6. Shrouds

Secure the leg shrouds to the underside of the worksurface with 4 wood screws per shroud in the holes shown below. Then attach 8 alligator clips to the underside of the surface inside the rail in the positions shown below.

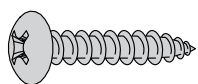

x 8



x 8



x 8

#10x1" Pan Head
Wood Screw (122850)

#10x5/8" Pan Head
Wood Screw (122800)

Alligator Clip
(117051)

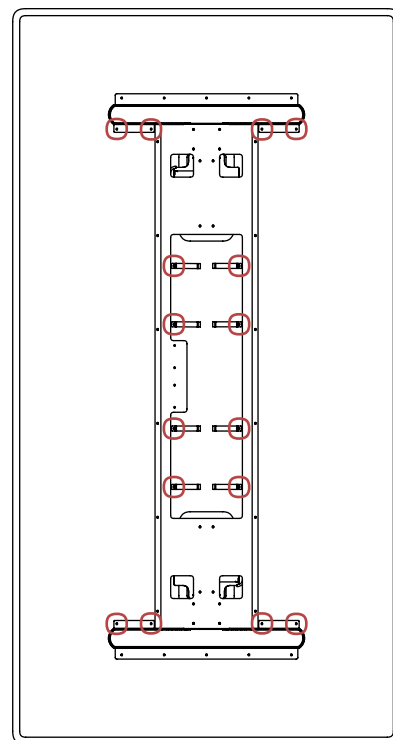
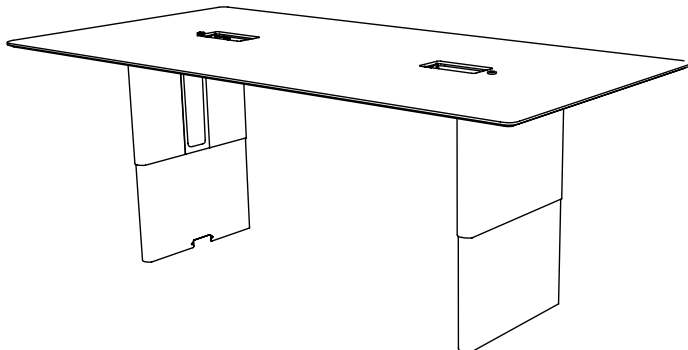

7. Optional: In-Surface Power w/ Double Flip Lid

Install the panel mounted network and HDMI adapters into their dedicated mounts on the side of the power box using the screws provided with each adapter, as shown to the right. Place the double flip lid over the convenience power outlets, if the surface is a wood grain laminate, orientate it in the direction of the grain. Flip the lid up in one direction, and align two of the linkages with the metal brackets. Secure these linkages to the metal bracket with two push rivets. Push the rivets through the metal bracket and then into the plastic linkages. Then flip the lid up in the other direction and repeat the same process. Finally loosen screws for the convenience power on the underside of the rail. Adjust the placement of the unit until there is a consistent gap all the way around the lid, then tighten the screws once more.



x 4

Black Push Rivet (0000822)

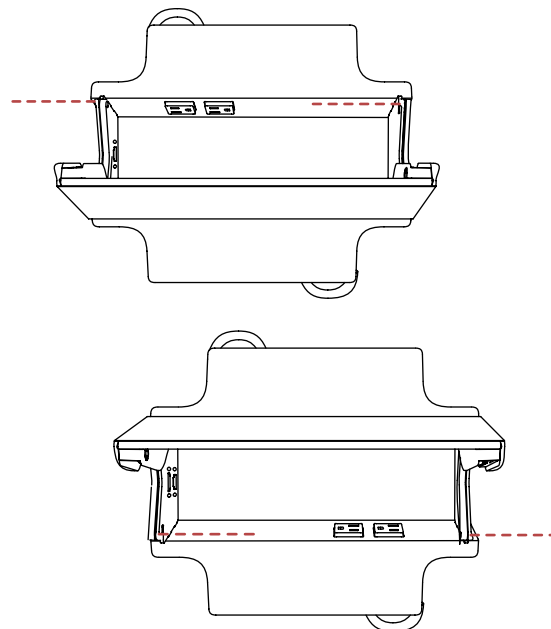
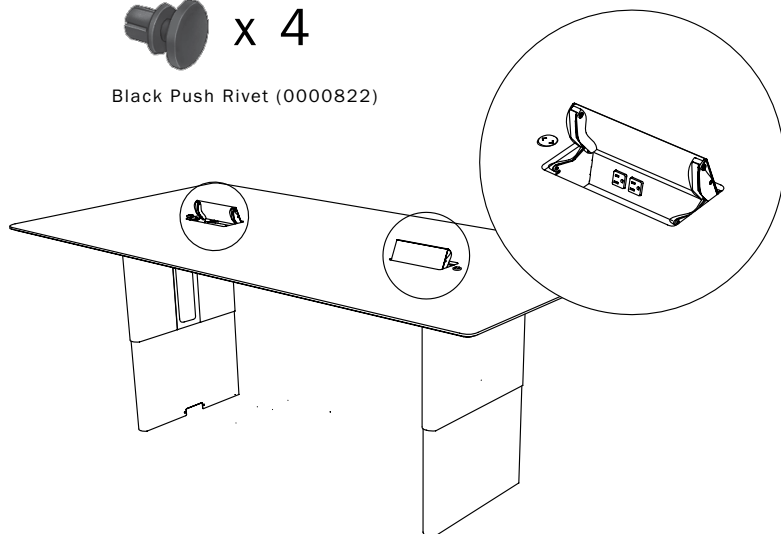
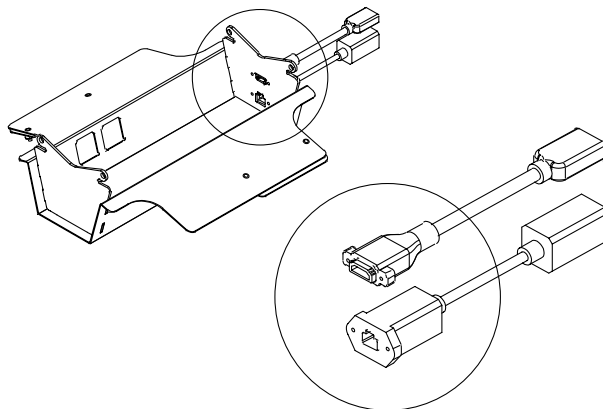

8.

Covers

Cover the openings in the legs with the magnetic cover plates. There are two covers per leg.

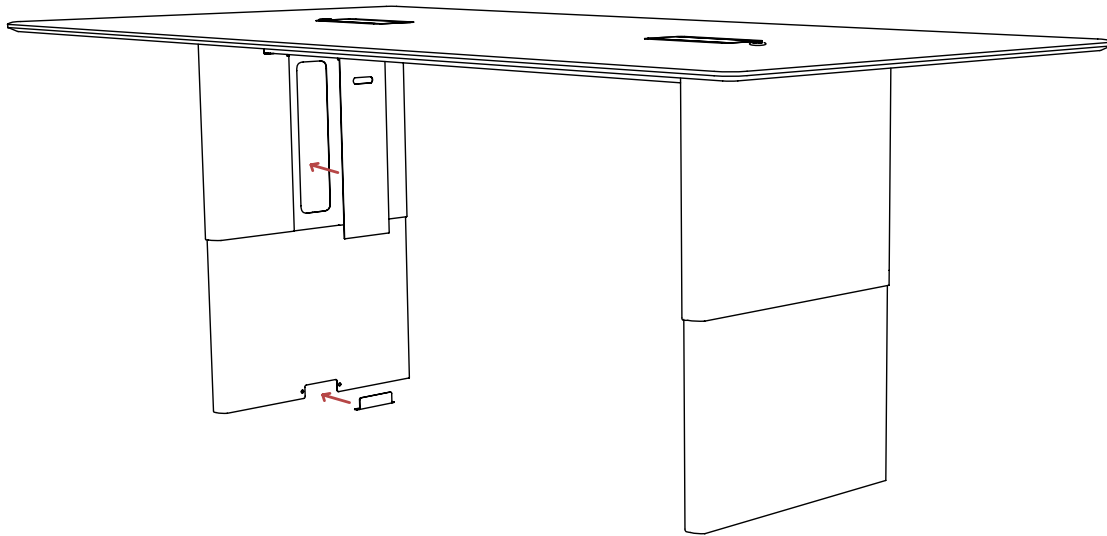

9.

Optional: Cable Bridge

Place the cable bridge between the two legs of the table. Then secure it on one side to the leg shroud with a 1/4-20 screw and 1/4" bushing. This creates a pivoting cover that can be flipped up to facilitate cable management.

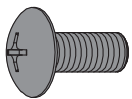

x 2



x 2

1/4-20x5/8" Pan Head
Phillips (117051)

1/4" Bushing
(0000826)

