

# Chicago Power Deck Instructions

## Tools Required

Cordless drill, magnetic insert-bit holder, 8" or longer driver extension, #2 insert or Pozidriv bit

### Step 1 – Assemble the Chicago infill with the hardware provided

ITEM NO.	SUPPLIED COMPONENTS	QTY
1	TFL PANEL	1
2	117010 - SCREW, MACH 8-32 X 2" PH ZINC	6-10
3	135686 - SPACER, 3/8" OD, 1_3/4 L, #10	6-10
4	486911 - CLIP, SINGLE SIDE WIRE MGMT	6-10
5	122800 - SMS #10 X 5/8 PTH ZINC	6-10

Picture from underside of TFL panel:

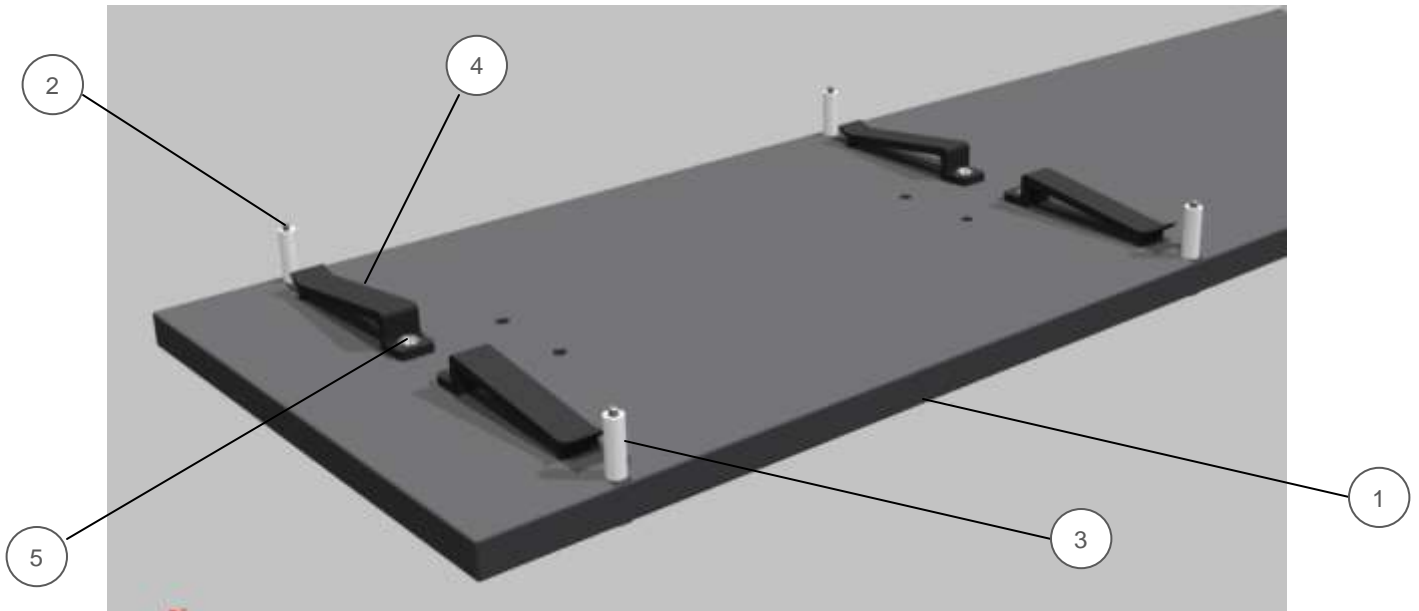

-Install spacers into predrilled dado's in the bottom of the panel

-Attach wire management clips using the pilot holes in the bottom of the panel and the #10 screws provided

-See step 2 for the mounting instructions

# Chicago Power Deck Instructions

## Step 2 –

ITEM NO.	SUPPLIED COMPONENTS	QTY
A	POWER DECK (REF. WFG PN TCICP) (see step 1 for detailed assembly instructions and BOM)	-
B	FACE PLATE AND DATA PORTS (Provided by customer)	-
C	TOP CENTER COMPONENT INFILL WITH POWER ACCESS LID	-
D	SCREW, MACH 8-32 X 2"	TYP 6 PER

Assemble the full bench table as described in INS-TNC-BT-ASSY document that came with the table.

**Note: Installation must be in accordance with the National Electrical Code and local codes. Electrically interconnected tables need to be mechanically connected.**

Refer to the following diagrams for suggested use and placement of electrical components in the city of Chicago (U.S.A.)

- Fasten the power deck
- with supplied #8-32 screws

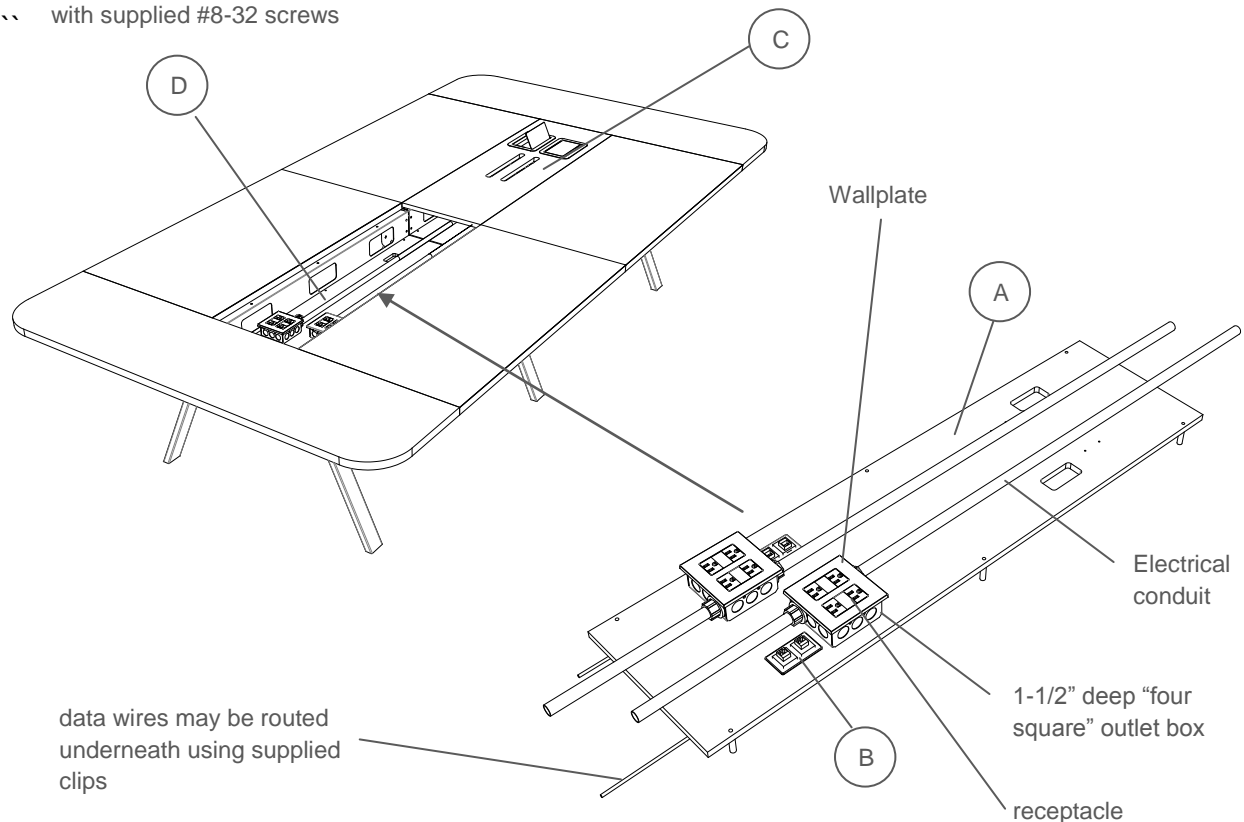

**Note: Center screen option isn't available with the Chicago power deck and component infill with power access lid.**

# Chicago Power Deck Instructions

The Tonic bench table has a blank deck option providing a platform to install electrical components in the city of Chicago. The power deck has pilot holes for outlet box placement that aligns to the power lid access found on the component infill above.

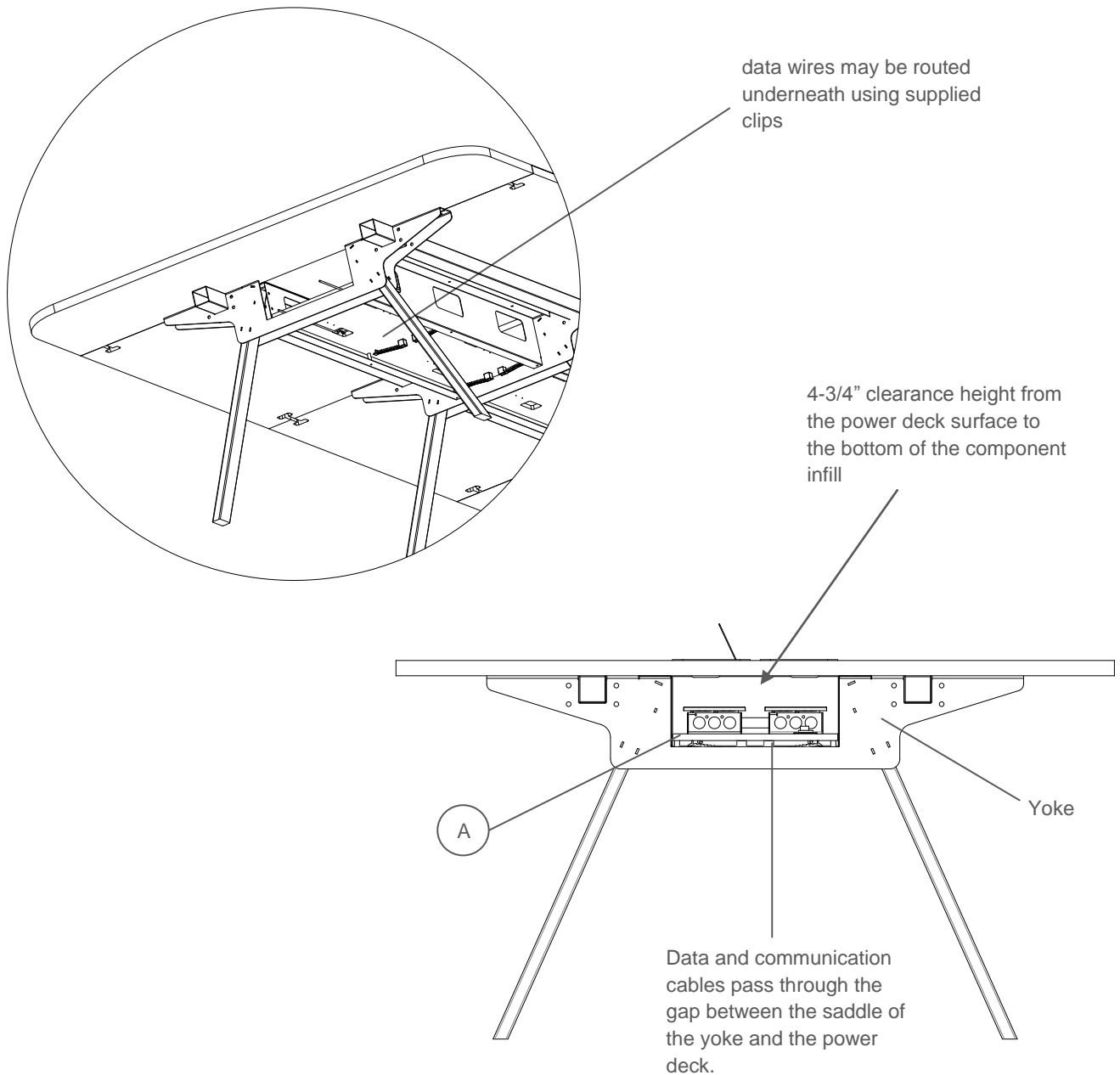

Operating, maintenance, and installation instructions are available at <https://watsonfq.box.com/installation>